

ASSEMBLY & OPERATING INSTRUCTIONS

Product: Portable stand

Model: Inox stand

Product size: \varnothing 450*2050mm

N.W: 9kg

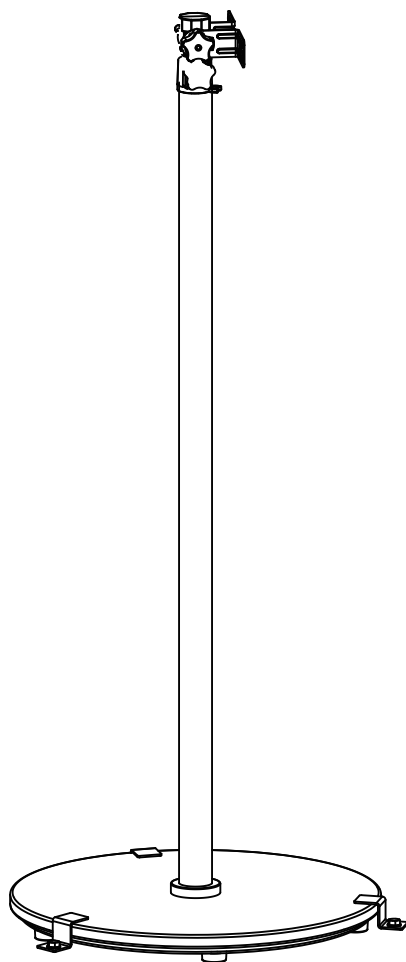

Please read the safety instructions carefully before first use and observe the safety instructions to prevent damage due to misuse, improper operation and improper environmental conditions.

ASSEMBLING AND USING YOUR PRODUCT

Accessories:

No	Accessories	Qty
1	Pole	1
2	Base	1
3	Base pad	5
4	Flat gasket	3
5	Spring washer	3
6	Hex screw	3
7	Expansion screw	3
8	Fix bracket	3
9	Hand screw	1
10	L shape bracket	2

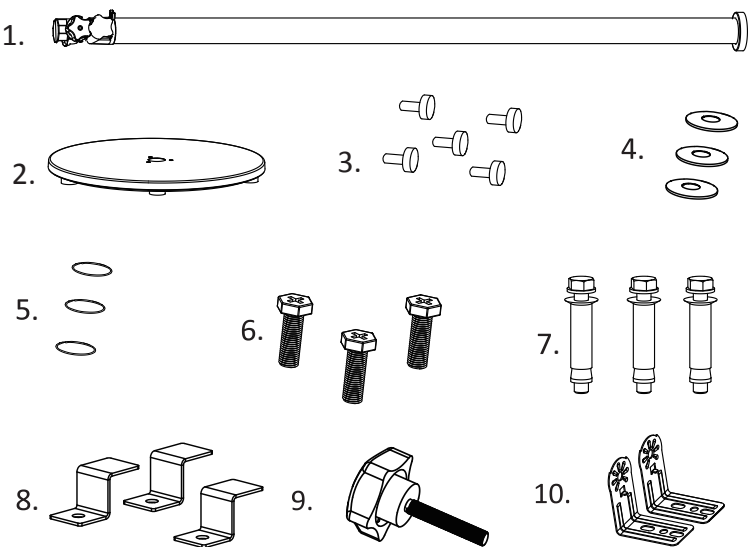

OPTION ONE:

- 1. Connect the base mat and the poles with the screws provided and tighten.
- 2. Attach the mat screws evenly and tightly to provide grip the disc mat.

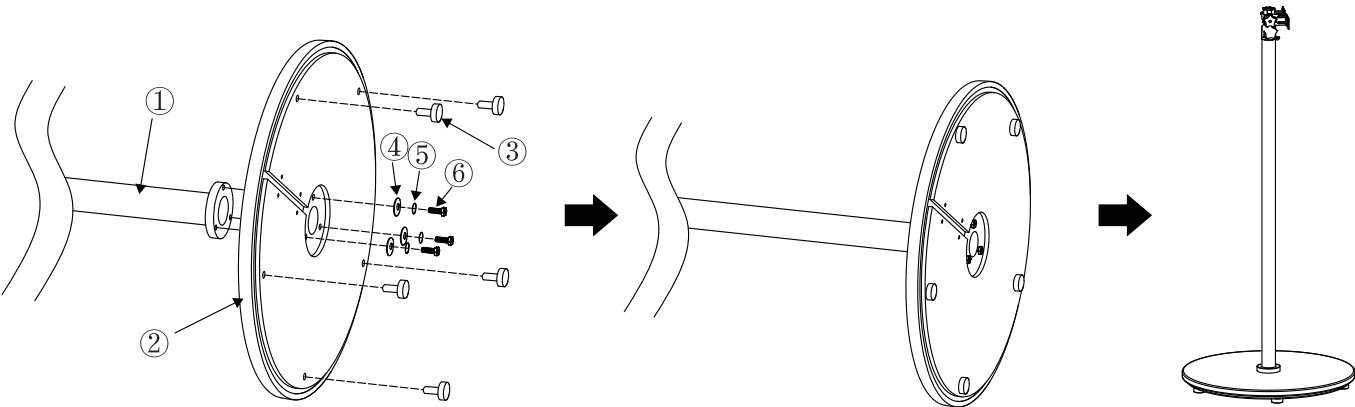

- 3. Loosen the handle screw. Affix the L shape bracket and tighten with the handle screw.

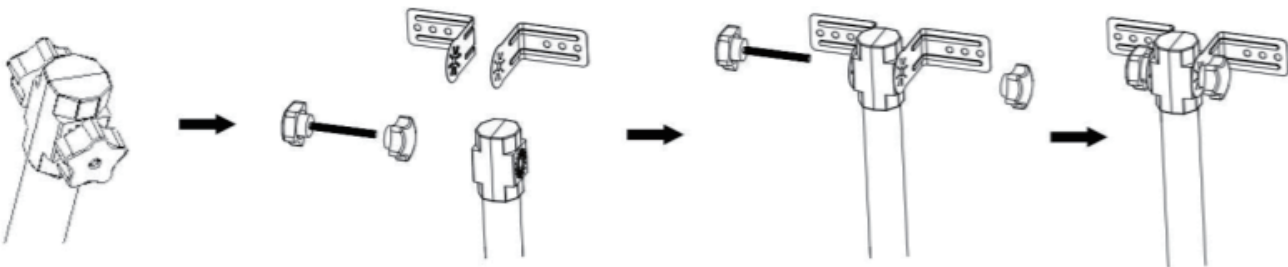

OPTION TWO:

1. Connect the base mat and the poles with the screws provided and tighten.

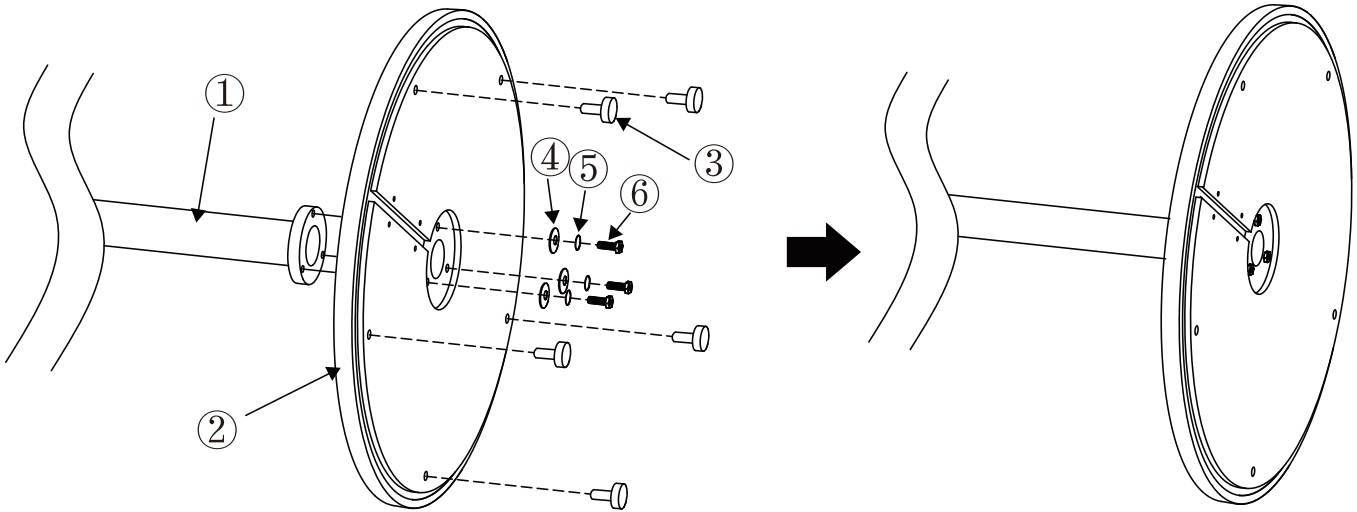

2. Drill holes on the hard floor and position the constructed stand upright with the screws provided & tighten.

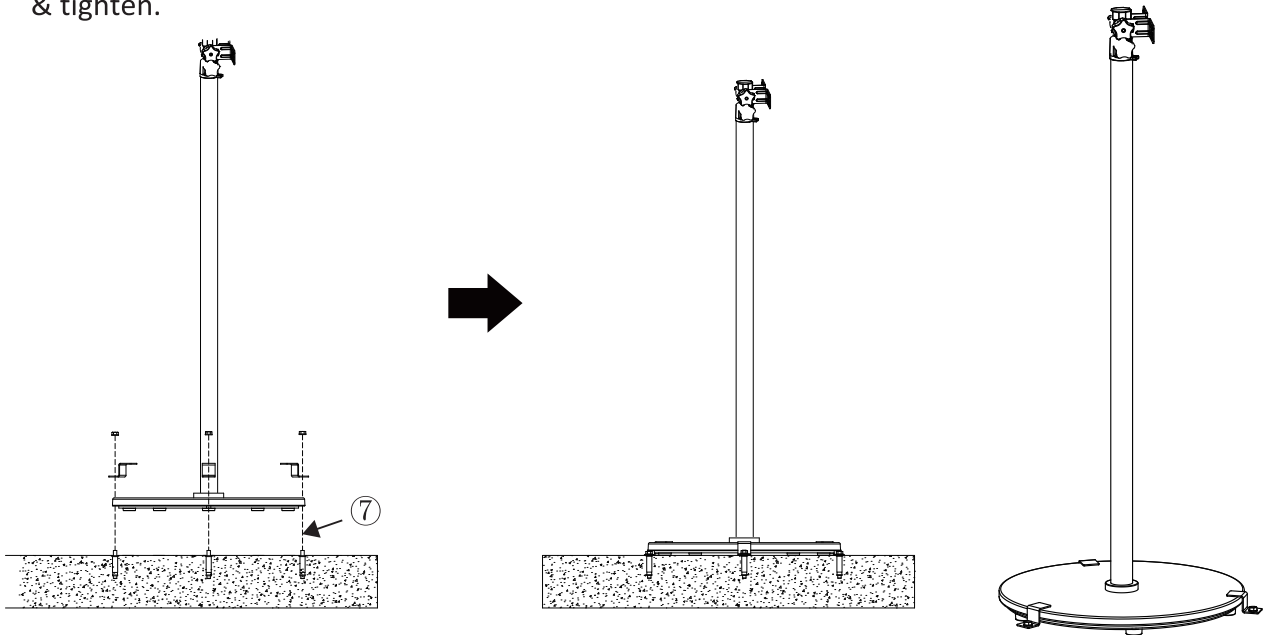

3. Loosen the handle screw. Affix the L shape bracket and tighten with the handle screw.

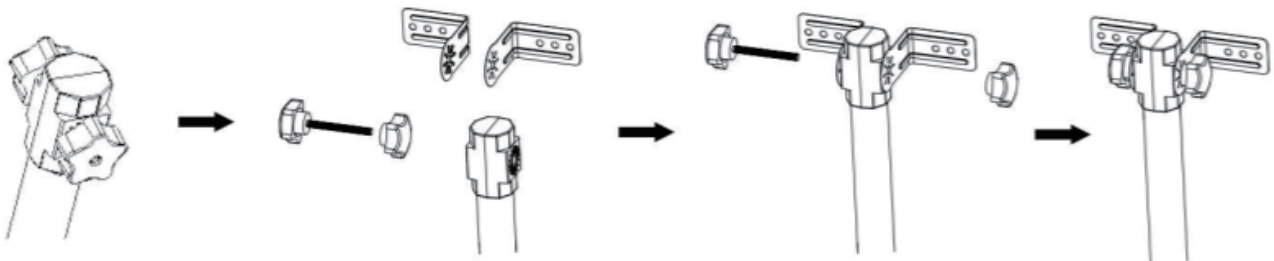

ADJUSTING THE HEIGHT

1. Loosen the handle screw by turning it to the left. This will allow you to extend the length of the pole to suit your needs.

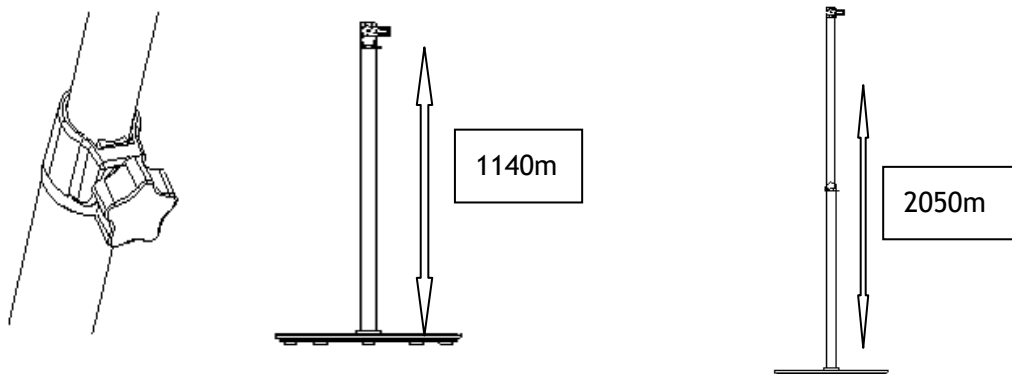

2. The L shape bracket can also be adjusted to different angles to suit to your preferences. Just twist the handle screw to the left to loosen, adjust as required and twist firmly to the right until it is tightly in place.

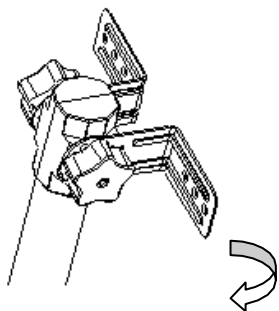

3. CLEANING

Regular and careful cleaning helps your infrared heater operate efficiently for many trouble-free years. To clean your heater, follow steps below:

1. Unplug the power cord for your safety before cleaning your appliance.
2. Make sure the heater is cool before continuing.
3. To keep the heater clean, the outer shell maybe cleaned with a soft, damp cloth. You may use a mild detergent if necessary. After cleaning, dry the unit with a soft cloth. (**CAUTION: DO NOT** let liquids enter the heater).
4. **DO NOT** use alcohol, gasoline, abrasive powders, furniture polish or rough brushes to clean the heater. This may cause damage or deterioration to the surface of the heater.
5. **DO NOT** immerse the heater in water
6. Wait until the heater is completely dry before use.

Storage: Store the heater in a cool, dry location when not in use to prevent dust and dirt build up. Use packaging carton to store.